

Scale 1:12,000



© Crown copyright Exeter City Council 100025345

22/01/2010

Newcourt Masterplan Area

APPENDIX A

Planning Services, Exeter City Council, Civic Centre, Paris Street, Exeter, EX1 1NN

Based upon the Ordnance Survey mapping with the permission of the Controller of Her Majesty's Stationery Office (c) Crown copyright. Unauthorised reproduction infringes Crown copyright and may lead to prosecution or Civil proceedings.



Exeter City Council

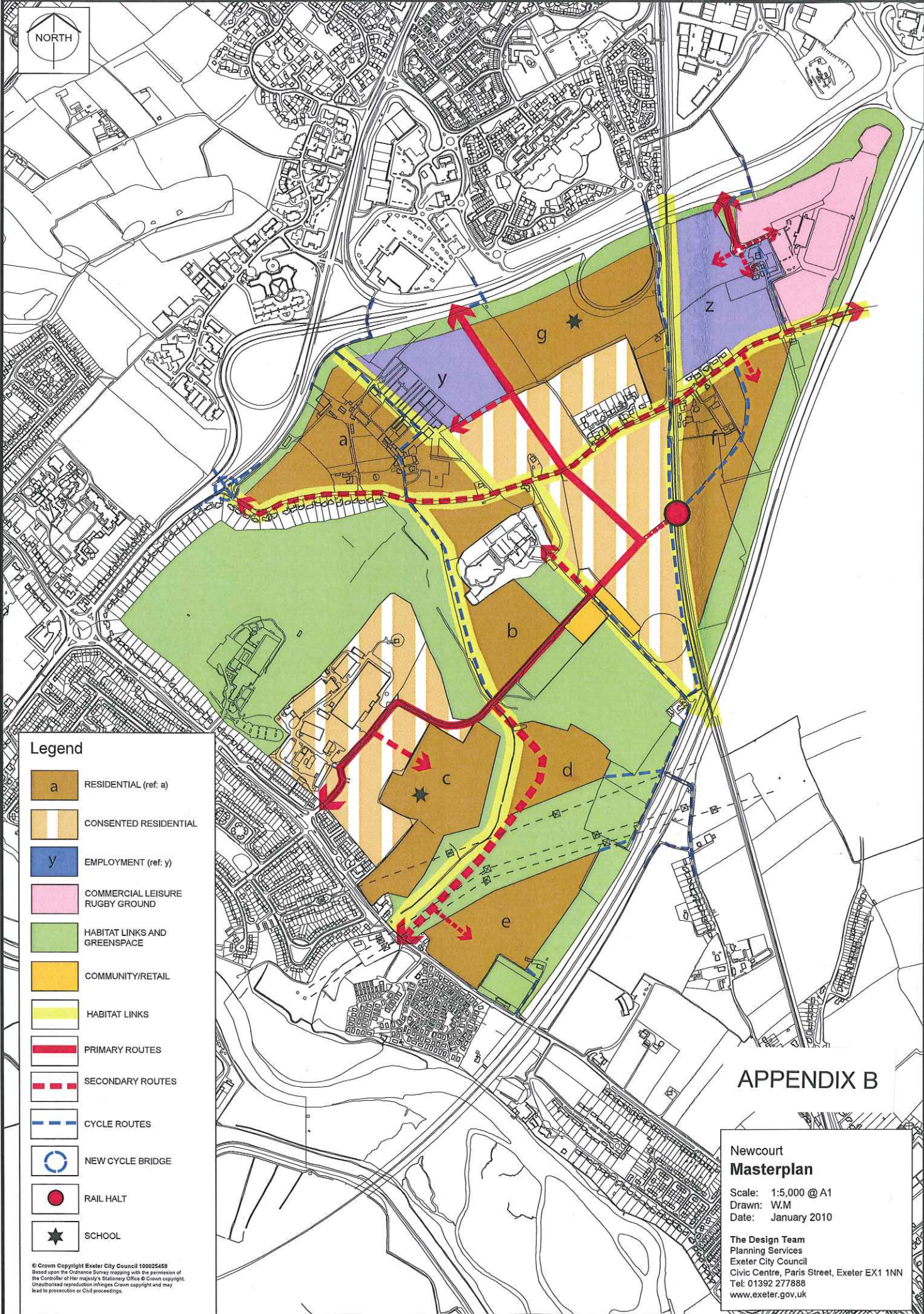

Legend

- a RESIDENTIAL (ref: a)
- CONSENTED RESIDENTIAL
- y EMPLOYMENT (ref: y)
- COMMERCIAL LEISURE RUGBY GROUND
- HABITAT LINKS AND GREENSPACE
- COMMUNITY/RETAIL
- HABITAT LINKS
- PRIMARY ROUTES
- SECONDARY ROUTES
- CYCLE ROUTES
- NEW CYCLE BRIDGE
- RAIL HALT
- ★ SCHOOL

APPENDIX B

Newcourt Masterplan
 Scale: 1:5,000 @ A1
 Drawn: W.M
 Date: January 2010

The Design Team
 Planning Services
 Exeter City Council
 Civic Centre, Paris Street, Exeter EX1 1NN
 Tel: 01392 277888
 www.exeter.gov.uk

© Crown Copyright Exeter City Council 100025458
 Based upon the Ordnance Survey mapping with the permission of the Controller of Her Majesty's Stationery Office © Crown copyright. Unauthorised reproduction infringes Crown copyright and may lead to prosecution or civil proceedings.